

# Heavy Nylon Insert

Heavy Pattern Nylon Insert Hex Nuts

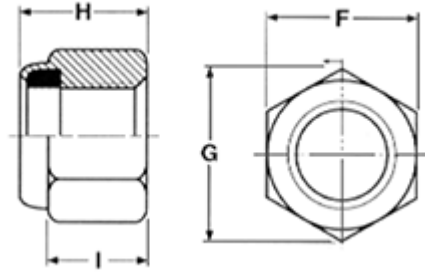

Gr. 2 Heavy Pattern  
Gr. 5 Heavy Pattern  
Gr. 8 Heavy Pattern

Gr. 2 Heavy Jam

Zinc = NU020----Z1

Zinc = NU050----Z1

Zinc = NU080----Z1

Zinc = NTU020----Z1

(\*Thickness not in dimension table)

Nominal Size	F	G	H		I
	Width Across Flats	Width Across Corners	Thickness Hex Nut		
			Max	Min	
1/4	1/2	.556	.390	.360	.290
5/16	9/16	.624	.453	.423	.335
3/8	11/16	.763	.562	.532	.392
7/16	3/4	.829	.609	.579	.464
1/2	7/8	.969	.718	.688	.544
5/8	1-1/16	1.175	.874	.844	.677
3/4	1-1/4	1.382	1.015	.895	.790
7/8	1-7/16	1.589	1.140	1.110	.883
1	1-5/8	1.796	1.312	1.250	1.000